

630A Apparatus Bushing

Features

- Manufactured from high quality epoxy resin
- Meeting requirements of EN 50180 & EN 50181 type C
- 100% factory tested
- In compliance with GB/T 4109 (IEC60137 6.0)

Design



Apparatus Bushing with Skirt
Part No. WECTG-DS2

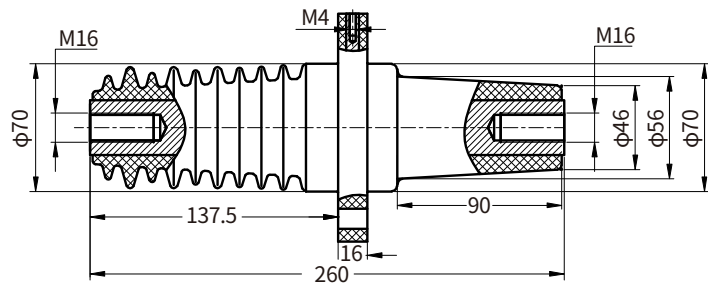

Apparatus Bushing in SF6
Part No. WECTG-CQ/285

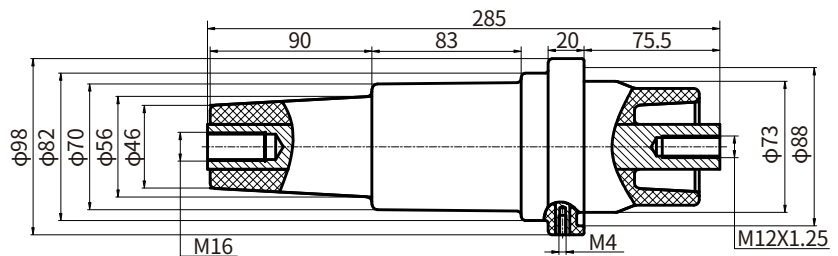

Apparatus Bushing in SF6
Part No. WECTG-FCQ

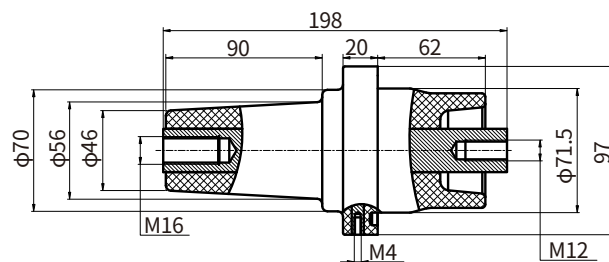

Dimension: mm

Technical Data

Voltage Class	12kV	
Continuous Current	630A	1250A*
AC Withstand Voltage	42kV for 1min	
Partial Discharge	13.2kV, ≤10pC	
Impulse Withstand Voltage (10 times for each polarity)	75kV	

Note: * refer to that current rating shall be clearly specified when order as both bushing dimension varies.